

BALL VALVES

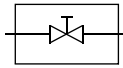

MODEL:- BVS-SQUARE DESIGN-2WAY

SERVICE:- AIR,GAS, WATER, OIL & STEAM

Application

This Ball Valves are precisely machined to produce superior quality and excellent performance. Close inspections are carried out at every stage of the production in order to maintain high quality standards. Non-vented robust valves with zero pressure drop characteristics gives unrestricted straight through flow in either direction.

Technical Data

Material Specification

Body	Carbon Steel Chrome Plated / Brass / St.Steel 304/316
Ball	SS 304 Standard, Optional SS 316
Spindle	SS 304 Standard, Optional SS 316
Seals	PTFE Standard
Handle	Aluminium Standard

Ordering References

SIZES	Material of Const.of Body/ Models			
	Carbon Steel	Brass	St. Steel 304	St. Steel 316
G1/8	BVS-01-BC	BVS-01-BB	BVS-01-BS	BVS-01-BSS
G1/4	BVS-02-BC	BVS-02-BB	BVS-02-BS	BVS-02-BSS
G3/8	BVS-03-BC	BVS-03-BB	BVS-03-BS	BVS-03-BSS
G1/2	BVS-04-BC	BVS-04-BB	BVS-04-BS	BVS-04-BSS
G3/4	BVS-06-BC	BVS-06-BB	BVS-06-BS	BVS-06-BSS
G1	BVS-08-BC	BVS-08-BB	BVS-08-BS	BVS-08-BSS

Bigger sizes available on request.

Features * * * * *

- Full Port Orifice
- High Flow Capacity.
- Positive Shut-off Leak Proof.
- Low Operation Torque.
- 100% Factory tested
- Valves available in BSP/NPT/BSPT Flanged to ASA, BS, DIN standards.

Applications

- Chemicals
- Petrochemicals
- Fertilizers
- Pharmaceuticals
- Hydraulics
- Pneumatics
- Refineries
- Laboratories

Airmatic

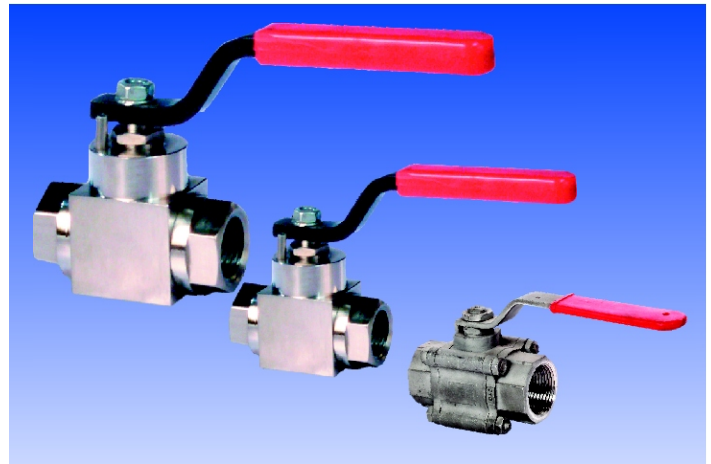

Pressure - Temperature

Pressure Range	Available from 10 Kg/cm ² to 200 Kg/cm ²
Temp.	Standard 120° C High Temp. Valves Available on request.

Model Ordering Code Instruction

BV	S	-	02	-	-	P	-	S	-	F	-	F
Type	Size	Conn	Max. Pressure	Mat. of Const.	Out Conn.							
BV-Ball Valve	01-G1/8	Blank - BSP	P - 10Kg/cm ²	S -St. Steel 304	F-Female							
	02-G1/4	N - NPT	P1 - 35Kg/cm ²	SS-St.Steel304	M-Male							
	03-G3/8	F150 -Flange ASA150	P2 - 70Kg/cm ²	C -Carbon Steel	In Conn.							
	04-G1/2	F300 -Flange ASA300	P3 - 135Kg/cm ²	B -Brass	F-Female							
	06-G3/4	B -Butt Weld	P4 - 200Kg/cm ²	IS -Investment Cast304	M-Male							
S-Square Design	08-G1		P5 - 400Kg/cm ²	ISS-Investment Cast316								
R-Round Design	12-G1.1/2											
F-Flange Design	16-G2											

Order Code : BVS - 02 - P - S - F - F

Dimensions

SIZES	Dimensions in MM				
	A	B	C	D	E
G1/8	40	28	27	15.3	18
G1/4	48	39	53	18.8	23
G3/8	53	49	58	22	28
G1/2	63	69	108	27	33
G3/4	82	80	129	34	42
G1	90	86	142	43	51

ALL DIMENSIONS ARE IN MM.

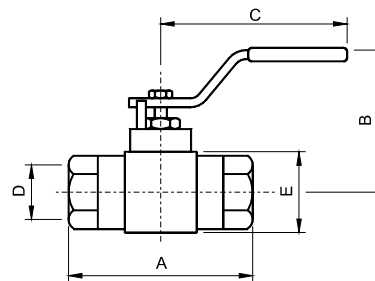

Shah Pneumatics

Regd. Office : 28-30, Navketan Industrial Estate,
Mahakali Caves Road, Andheri (East),
Mumbai - 400 093, INDIA.
Phone : +91-22-6695 1090 Fax : +91-22-26875317
E-mail : shahpneu@bom3.vsnl.net.in
Website : www.shah-pneumatics.com

BALL VALVES CAT.