

# SOLENOID VALVES

## 3/2 - PILOT OPERATED-COMPACTSERIES

TYPE : SS 231 - NC

SS 232 - NO

SINGLE SOLENOID SPRING RETURN  
WITH MANUAL OVERRIDE

### Application

When the voltage supply is given to the solenoid it is energised & the valve is actuated. It remains actuated until the solenoid is de-energised & returns to normal position by spring force.

FOR DRY OR LUBRICATED AIR & INERT GASES.

### Ordering References

# Airmatic



Port Sizes	Sectional Area in mm <sup>2</sup>	Flow Factor		Power Consumption			Model / Ref No			
				DC in watts	AC in VA		Valve*	Coil	Plug	Voltage AC / DC
					Pull	Hold				

MODEL :- 231 Normally Closed  
232 Normally Open

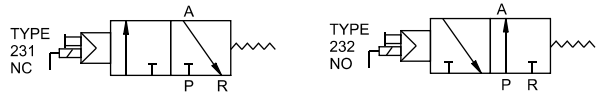

## Aluminium Body

Port Size	Sectional Area (mm <sup>2</sup> )	Flow Factor (Lit/Min)	Flow Factor (CV)	DC Power (W)	AC Power (VA)	AC Power (VA)	Model / Ref No	Coil	Plug	Voltage (AC/DC)
G1/8	12	800	0.67	2.5 W	6 VA	3 VA	SS231-01-008-A-N	EF	PEL	12
G1/4	16	1200	0.89	12V - 2.5W	24V - 7.0	3.5VA	SS231-02-008-A-N	DF	PD	24
G3/8	30	2000	1.67		24V - 3W	110V - 5.0	2.5VA		SS231-03-008-A-N	PDL
					220V - 4.0	2 VA				220

\* Consult the technical sales department for manifold details.

### Material Specification

Body	Aluminium optional Brass
Internals	Aluminium
Seals	Standard Nitrile Optional Viton

### Technical Data

RESPONSE TIME	0.05 sec.
MAX. WORKING FREQUENCY	5 To 10 cycles / sec.
VOLTAGE FLUCTUATION	+/-10%
ELECTRICAL CONNECTION	DIN PLUG CONNECTION
PLUG CONNECTOR	PD/PE STANDARD PLUG
	PDL/PEL STANDARD PLUG WITH LED
DUTY CYCLE / INSULATION	100% / CLASS F-STANDARD
DEGREE OF PROTECTION	STANDARD IP 65 (DIN 40050)

### Condition of use

Minimum Operating Pressure	1.5 Kg/Cm <sup>2</sup>
Maximum Operating Pressure	8 Kg/Cm <sup>2</sup>
Max. Operating Temp.	60° C

### Model Ordering Code Instruction

SS - 231 - 01 - 008 - A - N - EF - PEL - 220V - AC

Type: Single Solenoid  
 Sizes: 01-G1/8, 02-G1/4, 03-G3/8, 04-G1/2  
 Pressure Range: 1.5 - 8 Kg/Cm<sup>2</sup>  
 Body Mat.: A-Aluminium, B-Brass  
 Seal Mat.: N-Nitrile, V-Viton  
 Coil Type: DF - Type D, 6VA; EF - Type E, 4.5VA; F-Class  
 Plug Type: PE/PD - Std; PEL/PDL - Led  
 Coil Voltage: 12-12V, 24-24V, 48-48V, 110-110V, 220-220V  
 3-3/2 Way: 1-NC, 2-NO  
 Blank - BSP, N - NPT

ORDER CODE : SS231-01-008-A-N-EF-PEL-220 VAC.

### Dimensions

TYPE SS 231-NC  
SS232-NO

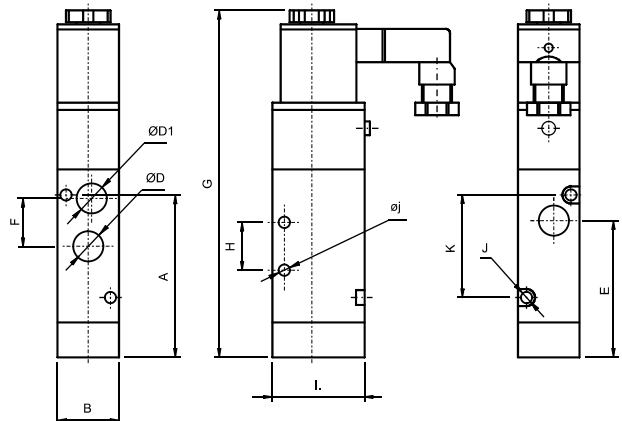

MODELS	DIMENSIONS (mm)											
	SIZES	A	B	D	D1	E	F	G	H	I	J	K
SS 231-01	G1/8	30	18	1/8	1/8	23	16	85.5	21	27	3.3	19
SS 231-02	G1/4	38.5	22	1/4	1/4	27.5	22.5	108	25	35	4.3	
SS 231-03	G3/8	44.5	27	3/8	3/8	32.5	24	119	30	40	4.3	

DIMENSIONS ARE IN MM.

## Shah Pneumatics

Regd. Office : 28-30, Navketan Industrial Estate,  
Mahakali Caves Road, Andheri (East),  
Mumbai - 400 093, INDIA.  
Phone : +91-22-6695 1090 Fax : +91-22-26875317  
E-mail : shahpneu@bom3.vsnl.net.in  
Website : www.shah-pneumatics.com