

SOLENOID VALVES

5/2 - PILOT OPERATED-COMPACT SERIES

TYPE : SS 252
SINGLE SOLENOID SPRING RETURN WITH MANUAL OVERRIDE

Application

When the voltage supply is given to the solenoid it is energised & the valve is actuated. It remains actuated until the solenoid is de-energised & returns to normal position by spring force.

FOR DRY OR LUBRICATED AIR & INERT GASES.

Ordering References

Port Sizes	Sectional Area in mm ²	Flow Factor		Power Consumption			MODEL / REF NO			
				DC in watts	AC in VA		Valve*	Coil	Plug	VOLTAGE
					Pull	Hold				

MODEL :- 252
Aluminium Body

G1/8	12	800	0.67	2.5 W	6 VA	3VA	SS252-01-008-A-N	EF	PEL	12
G1/4	16	1100	0.89	12V - 2.5W	24V - 7.0	3.5VA	SS252-02-008-A-N	DF	PD	24
G3/8	30	2000	1.68		110V - 5.0	2.5VA	SS252-03-008-A-N		PDL	110
G1/2	50	3300	2.79	24V - 3W	220V - 4.0	2 VA	SS252-04-008-A-N			220

* Contact our sales department for manifold details.

Material Specification

Body	Aluminium optional Brass
Internals	Aluminium
Sealing Disc	Standard Nitrile Optional Viton

Technical Specification

RESPONSE TIME	0.05 Sec.	
MAX. WORKING FREQUENCY	3 to 5 Cycles / Sec.	
VOLTAGE FLUCTUATION	+/-10%	
ELECTRICAL CONNECTION	DIN PLUG CONNECTION	
PLUG CONNECTOR	PD/PE	STANDARD PLUG
	PDL/PEL	STANDARD PLUG, WITH LED
DUTY CYCLE / INSULATION	100% / CLASS F-STANDARD	
DEGREE OF PROTECTION	STANDARD IP 65 (PIN 40050)	

Condition of use

Minimum Operating Pressure	1.5 Kg/Cm ²
Maximum Operating Pressure	8 Kg/Cm ²
Max. Operating Temp.	60° C

Model Ordering Code Instruction

SS	-	252	-	01	-	008	-	A	-	N	-	EF	-	PEL	-	220V-AC
Type		Sizes		Pressure Range	Body Mat.	Seal Mat.	Coil Type	Plug Type	Coil Voltage							
N - Namur		01-G1/8		1.5 - 8 Kg/Cm ²	A-Aluminium	N-Nitrile	DF - Type	PE/PD - Std	12 - 24V AC							
2-Pilot Operated		02-G1/4			B-Brass	V-Viton	D, 6VA	PEL/PDL-Led	24 - 24V DC							
		03-G3/8			S-SS304		EF - Type		48 - 48V							
		04-G1/2					E, 4.5VA		110-110V							
					Blank - BSP		F-Class		220-220V							
					N - NPT											

ORDER CODE : SS252-01-008-A-N-EF-PEL-220 VAC.

Airmatic

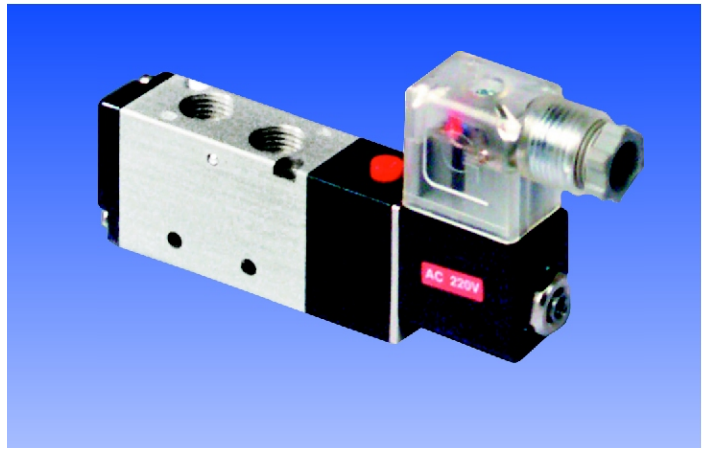

Dimensions

TYPE : SS252

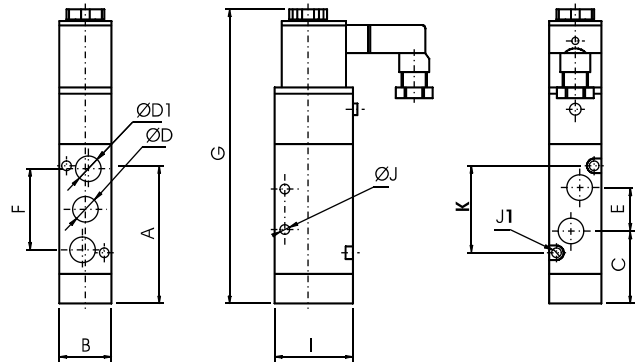

MODELS	DIMENSIONS (mm)											WEIGHTS		
	A	B	C	D	D1	E	F	G	H	I	J/J1	K		KGS
SS 252-01	42.2	18	20.2	G1/8	G1/8	16	28	98	14	27	3,3	30		0.12
SS 252-02	50.5	22	21.2	G1/4	G1/8	21	36	116.5	20	35	4.3/3.2	38		0.22
SS 252-03	62.5	27	28	G3/8	G1/4	24	45	135	24	40	4.3	50		0.31
SS 252-04	88	34	39	G1/2	G1/2	36	63	168	28	50	5.5	72		0.59

DIMENSIONS ARE IN MM.

Shah Pneumatics

Regd. Office : 28-30, Navketan Industrial Estate,
 Mahakali Caves Road, Andheri (East),
 Mumbai - 400 093, INDIA.

Phone : +91-22-6695 1090 Fax : +91-22-26875317

E-mail : shahpneu@bom3.vsnl.net.in

Website : www.shah-pneumatics.com