

AIR OPERATED VALVES

2/2 PILOT OPERATED - HIGH TEMP.

TYPE : PS221G

Airmatic

FOR AIR/ WATER/ OIL

Application

These valves are suitable for applications like washing machine in Food, Medical & Chemical Industries for its fast response & low pressure applications.



| Port Size G | Model no. | Orifice in mm | Maximum working pressure (Kg/cm ²) | Maximum working temperature Range of Fluid °C | Control Pressure range Kg/cm ² | Flow valve CV. m ³ /hr |
|----------------|-----------|---------------|--|---|---|-----------------------------------|
| | | | | | | |

MODEL : PS- 221G - Normally Closed

Brass Body/ Pipe Mounted

| | | | | | | |
|-------|-----------|-----|--------|------------|--------|----|
| 1/2 | PS-221G04 | 1.5 | 2 to 6 | 5 to 150°C | 3 to 6 | 4 |
| 3/4 | PS-221G06 | 2.0 | | | | 5 |
| 1 | PS-221G08 | 2.5 | | | | 10 |
| 1 1/4 | PS-221G10 | 4.0 | | | | 25 |
| 1 1/2 | PS-221G12 | 4.0 | | | | 25 |
| 2 | PS-221G16 | 5.0 | | | | 40 |

Material Specification

| | |
|----------|-----------|
| Body | Brass |
| Actuator | Aluminium |
| Seat | Viton |

Dimensions

TYPE : PS 221G

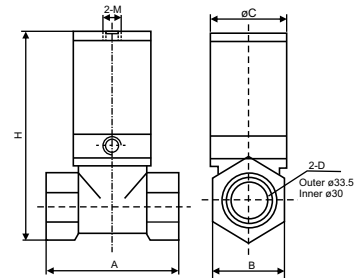

Technical Specifications

| | |
|----------|-----------------------------|
| Actuator | Spring Return Single Acting |
|----------|-----------------------------|

Model Ordering Code Instruction

| | | | | | | | | | | | | | |
|-------------------|-----------------|---|--------------------|-------------------------|------------|---|---|------------------------------------|-----|---|------------------------|---|----------------|
| P | S | - | 2 | 2 | 1 | - | G | 04 | 006 | - | B | - | V |
| ┆ | ┆ | | ┆ | ┆ | ┆ | ┆ | ┆ | ┆ | ┆ | | ┆ | | ┆ |
| P- Pilot Operator | S-Spring Return | | 2- Pilot 2- 2/2way | 1- Type Normally closed | Globe Type | | Size 04 - G 1/2 06 - G 3/4 08 - G 1 10 - G 1 1/4 12 - G 1 1/2 16 - G 2 | Pressure 006-0-6Kg/cm ² | | | Body Material B- Brass | | Seat V - Viton |

ORDER CODE : PS - 221 - G - 04 - 006 - B - V

DIMENSIONS ARE IN MM

Shah Pneumatics

Regd. Office : 28-30, Navketan Industrial Estate,
Mahakali Caves Road, Andheri (East),
Mumbai - 400 093, INDIA.
Phone : +91-22-6695 1090-94 Fax: +91-22-2687 5317
E-mail : shahpneu@bom3.vsnl.net.in
Website : www.shah-pneumatics.com